

Magnetic Lock Installation Instructions

Introduction

First4Magnets supply 180kg, 280kg, 320kg and 500kg magnetic locks. Different specifications of the product tensile strength; with lock status indicator and unlock delay. There is a variety of different ways to install a full range of magnetic locks. Compatibility includes access to a control system, building intercom control system, fire control systems and so many other access control systems. Suitable installation for fire doors, on almost all types of wooden doors, stainless steel doors, steel doors and glass doors frames. The modular design makes the product functional, have easy installation, upgrade your door, maintenance is also easy to implement.

Structure for magnetic lock installation

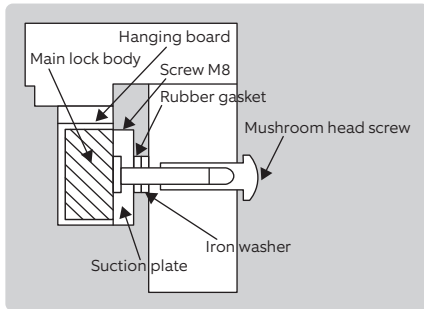

Sectional view of mounting structure of hanging type

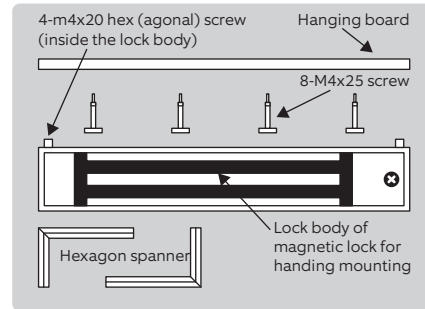

Mounting type

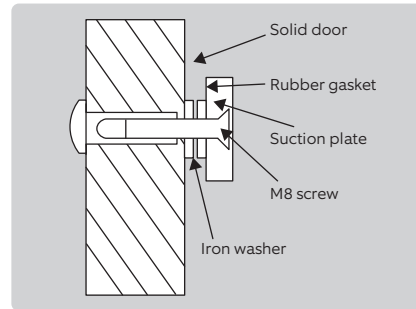

Sectional view of mounting structure for iron absorption board of hanging type

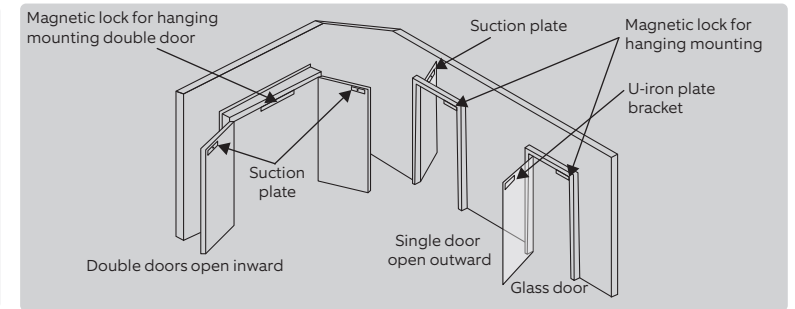

Rendering of typical installation

PCB Structure and Electrical Wiring

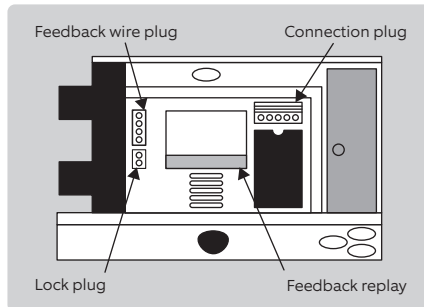

V+ Red wire: Anode power supply
V- Black wire: Cathode power supply
NO Yellow wire: Normally open port
NC White wire: Normally close port

Indicator light
Red: Suction plate Completely pull in
Green: not pull in well
Lights off: Without electricity

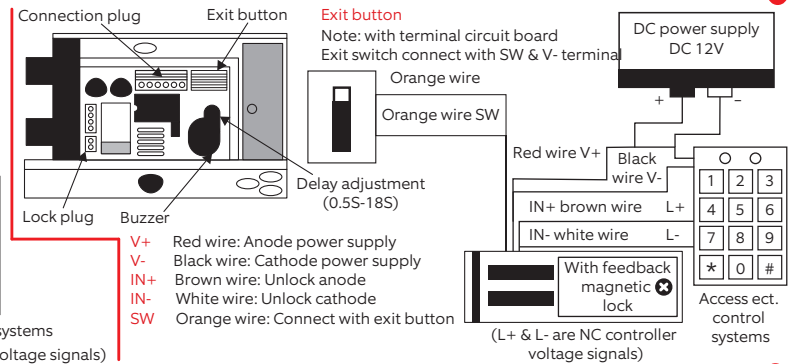
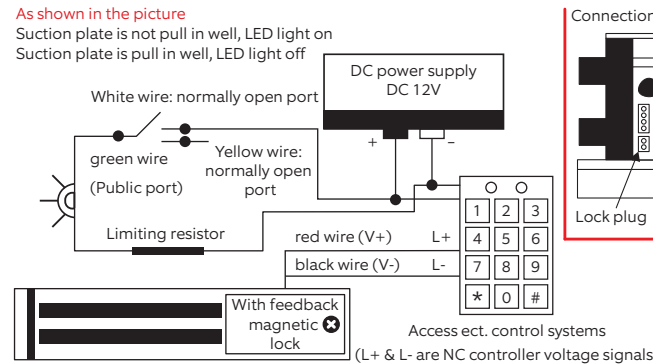

Typical Installation

